

**PROFIL: oś Łąkociny - Sulisław**  
Poziom Porównawczy: 137.00 m n.p.m.

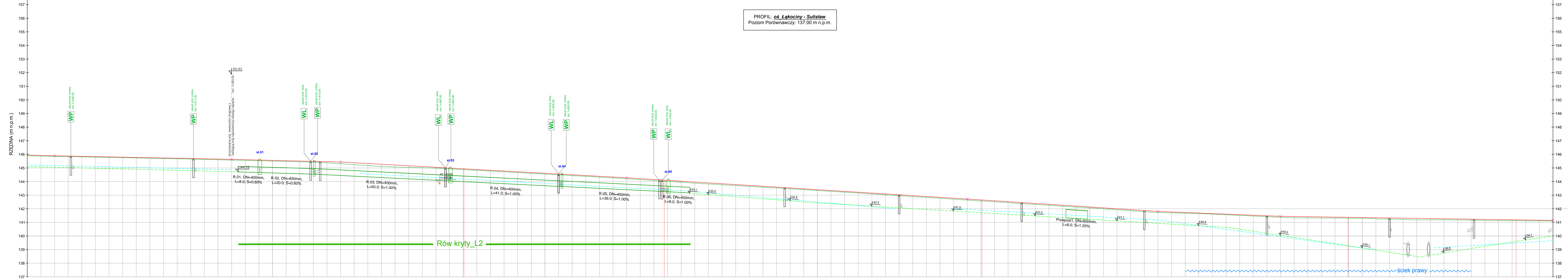

Kilometraż	Rzędna (m.n.p.m.)
15.00	145.92
20.00	145.89
25.00	145.87
30.00	145.85
35.00	145.83
40.00	145.81
45.00	145.79
50.00	145.77
55.00	145.75
60.00	145.73
65.00	145.71
70.00	145.69
75.00	145.67
80.00	145.65
85.00	145.63
90.00	145.61
95.00	145.59
100.00	145.57
105.00	145.55
110.00	145.53
115.00	145.51
120.00	145.48
125.00	145.46
130.00	145.44
135.00	145.43
140.00	145.41
145.00	145.39
150.00	145.37
155.00	145.35
160.00	145.33
165.00	145.31
170.00	145.29
175.00	145.27
180.00	145.25
185.00	145.23
190.00	145.21
195.00	145.19
200.00	145.17
205.00	145.15
210.00	145.13
215.00	145.11
220.00	145.09
225.00	145.07
230.00	145.05
235.00	145.03
240.00	145.01
245.00	144.99
250.00	144.97
255.00	144.95
260.00	144.93
265.00	144.91
270.00	144.89
275.00	144.87
280.00	144.85
285.00	144.83
290.00	144.81
295.00	144.79
300.00	144.77
305.00	144.75
310.00	144.73
315.00	144.71
320.00	144.69
325.00	144.67
330.00	144.65
335.00	144.63
340.00	144.61
345.00	144.59
350.00	144.57
355.00	144.55
360.00	144.53
365.00	144.51
370.00	144.49
375.00	144.47
380.00	144.45
385.00	144.43
390.00	144.41
395.00	144.39
400.00	144.37
405.00	144.35
410.00	144.33
415.00	144.31
420.00	144.29
425.00	144.27
430.00	144.25
435.00	144.23
440.00	144.21
445.00	144.19
450.00	144.17
455.00	144.15
460.00	144.13
465.00	144.11
470.00	144.09
475.00	144.07
480.00	144.05
485.00	144.03
490.00	144.01
495.00	143.99
500.00	143.97
505.00	143.95
510.00	143.93
515.00	143.91
520.00	143.89
525.00	143.87
530.00	143.85
535.00	143.83
540.00	143.81
545.00	143.79
550.00	143.77
555.00	143.75
560.00	143.73
565.00	143.71
570.00	143.69
575.00	143.67
580.00	143.65
585.00	143.63
590.00	143.61
595.00	143.59
600.00	143.57
605.00	143.55
610.00	143.53
615.00	143.51
620.00	143.49
625.00	143.47
630.00	143.45
635.00	143.43
640.00	143.41
645.00	143.39
650.00	143.37
655.00	143.35
660.00	143.33
665.00	143.31
670.00	143.29
675.00	143.27
680.00	143.25
685.00	143.23
690.00	143.21
695.00	143.19
700.00	143.17
705.00	143.15
710.00	143.13
715.00	143.11
720.00	143.09
725.00	143.07
730.00	143.05
735.00	143.03
740.00	143.01
745.00	142.99
750.00	142.97
755.00	142.95
760.00	142.93
765.00	142.91
770.00	142.89
775.00	142.87
780.00	142.85
785.00	142.83
790.00	142.81
795.00	142.79
800.00	142.77
805.00	142.75
810.00	142.73
815.00	142.71
820.00	142.69
825.00	142.67
830.00	142.65
835.00	142.63
840.00	142.61
845.00	142.59
850.00	142.57
855.00	142.55
860.00	142.53
865.00	142.51
870.00	142.49
875.00	142.47
880.00	142.45
885.00	142.43
890.00	142.41
895.00	142.39
900.00	142.37
905.00	142.35
910.00	142.33
915.00	142.31
920.00	142.29
925.00	142.27
930.00	142.25
935.00	142.23
940.00	142.21
945.00	142.19
950.00	142.17
955.00	142.15
960.00	142.13
965.00	142.11
970.00	142.09
975.00	142.07
980.00	142.05
985.00	142.03
990.00	142.01
995.00	141.99
1000.00	141.97
1005.00	141.95
1010.00	141.93
1015.00	141.91
1020.00	141.89
1025.00	141.87
1030.00	141.85
1035.00	141.83
1040.00	141.81
1045.00	141.79
1050.00	141.77
1055.00	141.75
1060.00	141.73
1065.00	141.71
1070.00	141.69
1075.00	141.67
1080.00	141.65
1085.00	141.63
1090.00	141.61
1095.00	141.59
1100.00	141.57
1105.00	141.55
1110.00	141.53
1115.00	141.51
1120.00	141.49
1125.00	141.47
1130.00	141.45
1135.00	141.43
1140.00	141.41
1145.00	141.39
1150.00	141.37
1155.00	141.35
1160.00	141.33
1165.00	141.31
1170.00	141.29
1175.00	141.27
1180.00	141.25
1185.00	141.23
1190.00	141.21
1195.00	141.19
1200.00	141.17
1205.00	141.15
1210.00	141.13
1215.00	141.11
1220.00	141.09
1225.00	141.07
1230.00	141.05
1235.00	141.03
1240.00	141.01
1245.00	140.99
1250.00	140.97
1255.00	140.95
1260.00	140.93
1265.00	140.91
1270.00	140.89
1275.00	140.87
1280.00	140.85
1285.00	140.83
1290.00	140.81
1295.00	140.79
1300.00	140.77
1305.00	140.75
1310.00	140.73
1315.00	140.71
1320.00	140.69
1325.00	140.67
1330.00	140.65
1335.00	140.63
1340.00	140.61
1345.00	140.59
1350.00	140.57
1355.00	140.55
1360.00	140.53
1365.00	140.51
1370.00	140.49
1375.00	140.47
1380.00	140.45
1385.00	140.43
1390.00	140.41
1395.00	140.39
1400.00	140.37
1405.00	140.35
1410.00	140.33
1415.00	140.31
1420.00	140.29
1425.00	140.27
1430.00	140.25
1435.00	140.23
1440.00	140.21
1445.00	140.19
1450.00	140.17
1455.00	140.15
1460.00	140.13
1465.00	140.11
1470.00	140.09
1475.00	140.07
1480.00	140.05
1485.00	140.03
1490.00	140.01
1495.00	139.99
1500.00	139.97

**Legenda:**

- projektowana niweleta drogi
- teren istniejący
- niweleta dna rowu przydrożnego
- niweleta dna drenażu PVC DN150
- st.01 opis proj. studni rowu krytego
- proj. rura i studnia rowu krytego
- R.08\_KD2\_DN=400mm opis projektowanego rowu krytego
- L=33.0; S=3.00%
- g 142.46 istn. infrastruktura - przecięcia z osią sieci
- 143.11.00 opis projektowanego wpustu deszczowego
- wpust deszczowy opis istniejącego wpustu deszczowego
- wpust deszczowy opis projektowanego wpustu deszczowego
- proj. wpust deszczowy z osadnikiem 50cm i przykanalikiem Ø 160

Powiatowy Zarząd Dróg  
ul. Staszica 1  
63-400 Ostrów Wielkopolski

PPID Kasalka  
ul. Staroprzygodzka 25,  
63-400 Ostrów Wielkopolski

Numer projektu: 527  
AutoCAD Civil 3D - 343-45382590, 390-65304897, 388-46619288

Przebudowa drogi nr 4332P  
Łąkociny - Janków Zalesny  
na odcinku Łąkociny - Sulisław

Projektant: mgr inż. Marcin Kasalka  
WK/P.0305/POOD/11

Opracował: mgr inż. Tomasz Dryjański

Juliy 2018r.  
**3.3**  
SKALA 1:500

PROFIL PODŁUŻNY